

# HOME SWEET HOME



April 1 – 30

We will be working mostly behind the scenes during our project launch beginning April 1. You will experience no interruption other than the presence of our construction partner, Selzer-Ornst and some demolition occurring to pave the way for things to come.

## What's Happening:

- 1 Lower Level *preparation* and *relocation of Mechanical Equipment*
- 2 *Preparation* and *relocation of Cycle Studio* to new space adjacent to current Studio

You may also access this information on our website at [www.thewac.com/homesweeterhome](http://www.thewac.com/homesweeterhome)

While we have developed a detailed project timeline, construction projects of this size and scope can run into challenges and setbacks. To make sure we're keeping you up to date, watch for our Home Sweeter Home information kiosk in the club lobby. You'll get a sneak peek at the entire transformation as well as materials and design elements.

**HOW SWEET IT IS!**

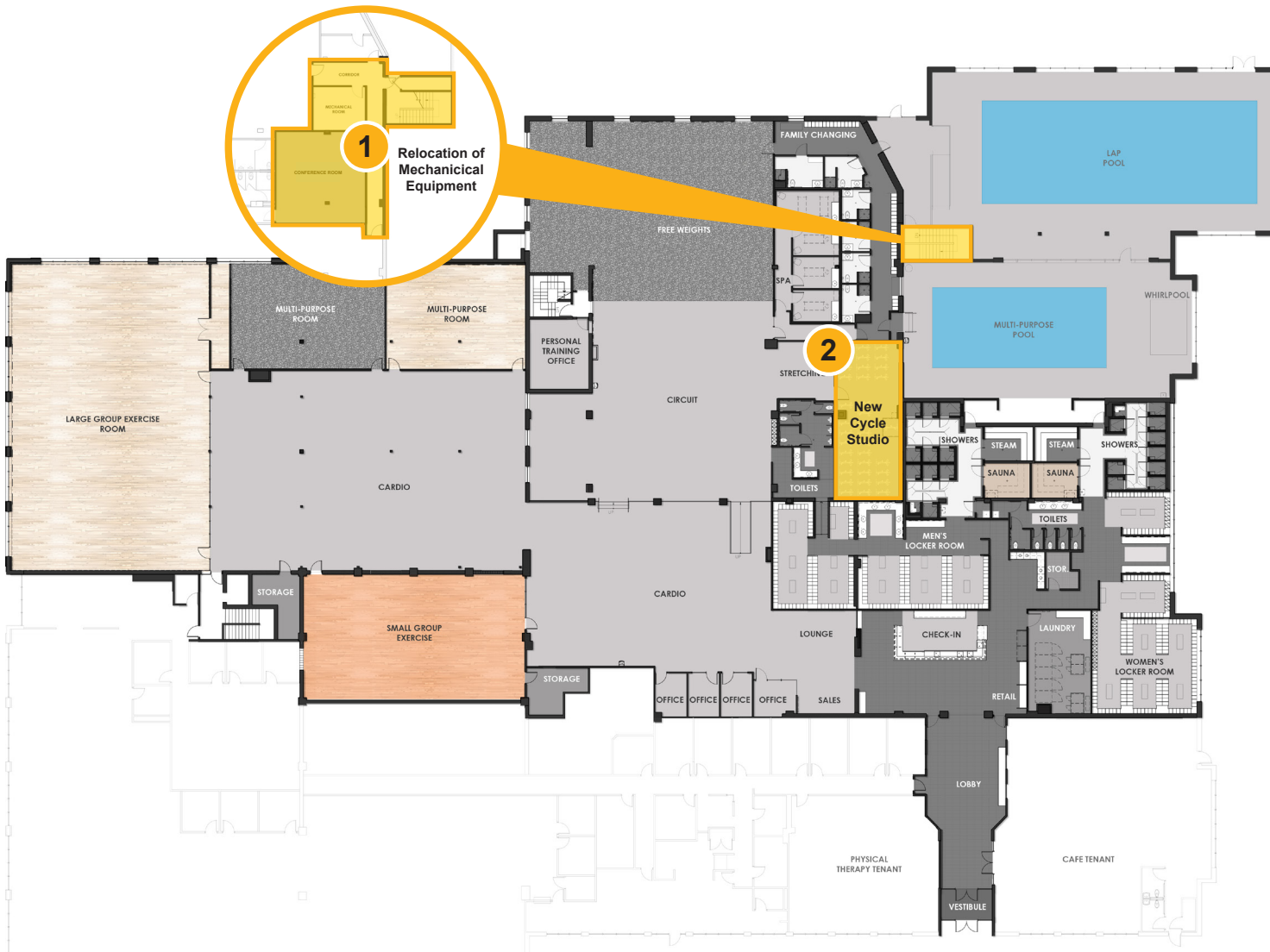

FIRST FLOOR PLAN